

CITY OF RANCHO MIRAGE



2010

Legend

- Critical Intersections
- Freeway
- Primary Arterial
(120' - 6 Lanes Divided)
- Major Arterial
(110' - 6 Lanes Divided)
- Minor Arterial
(110' - 4 Lanes Divided)
- Collector
(88' - 4 Lanes Divided)

Source: 2005 Rancho Mirage General Plan, Circulation Element

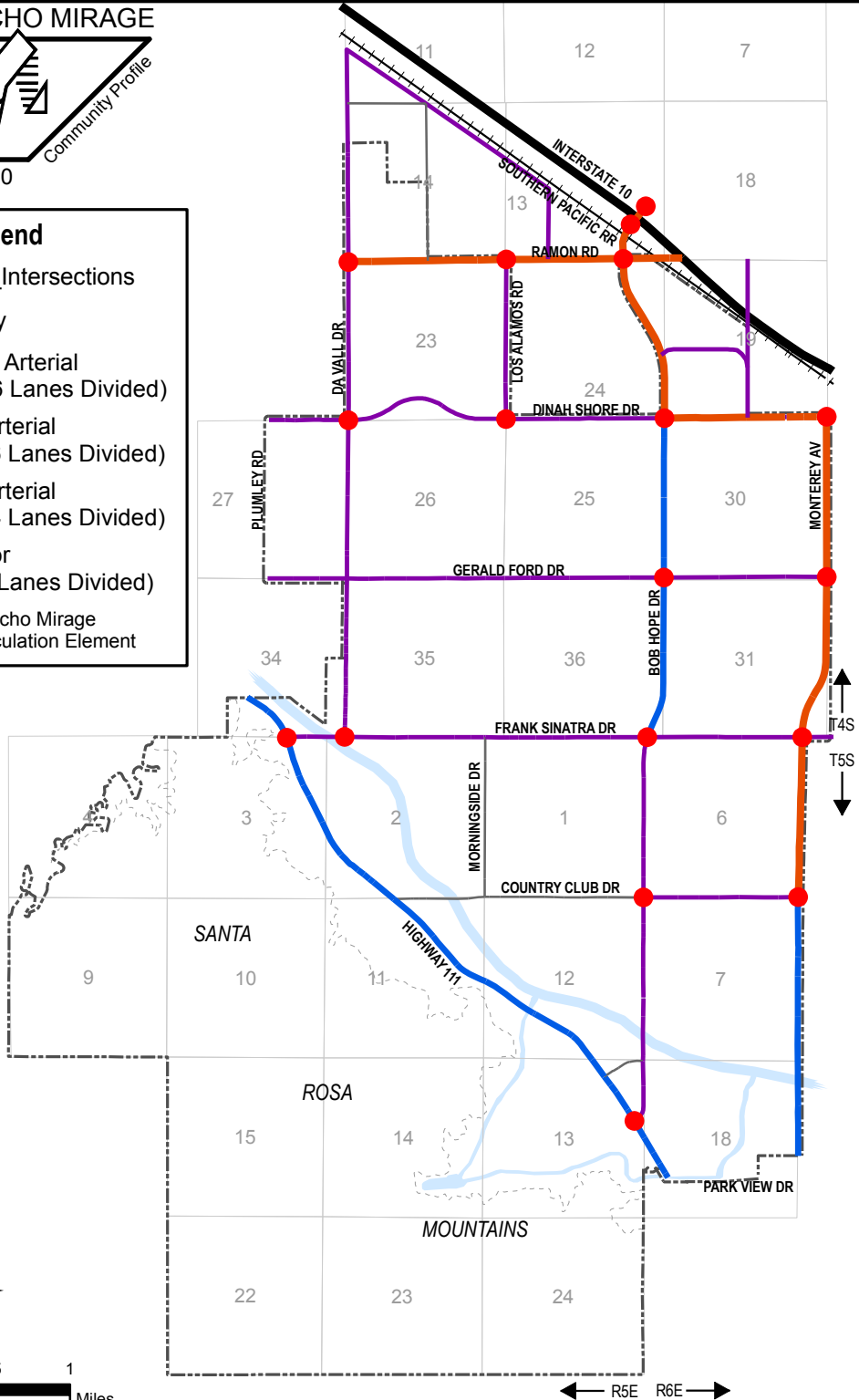

Revised 09-2010

2005 General Plan Circulation Map

Department of Community Development ● Planning Division